

SMARTWIZ⁺

TM

mirror

Quick User Guide

User Manuals and FAQs: <https://www.design-store.com/en/support/smartwiz>

Support Email: support@disign.org



Package contents



SMARTWIZ⁺ mirror

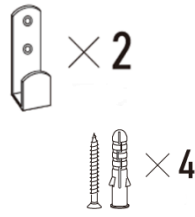

Brackets



AC adaptor

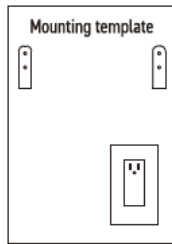

Mounting template

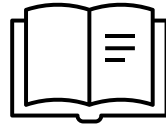

User manual



Wall mounting procedure

List of components

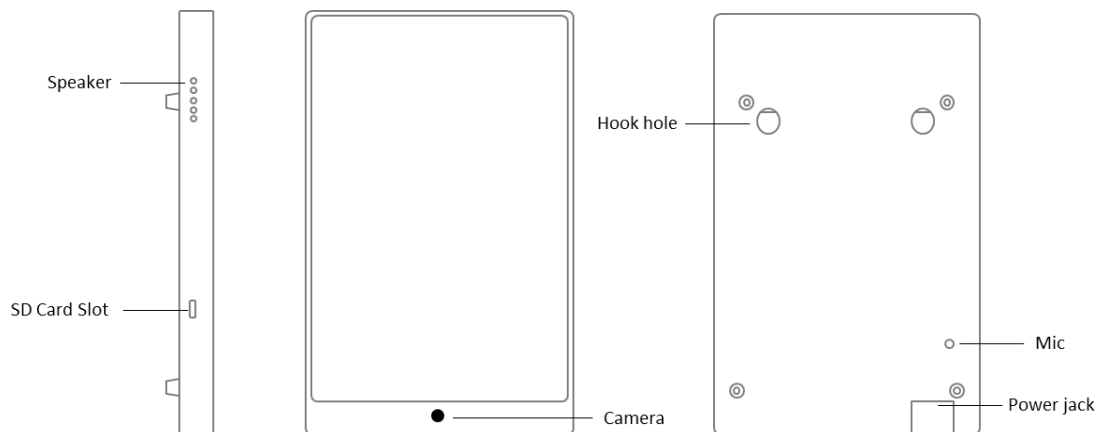

Specifications

Product name: SMARTWIZ⁺ mirror

Model: SM215-X8M-A1 (Please check the product label located on the back.)

Power input: 12V , $\overline{\text{---}}$ 3.0A

Operating environment: Indoor only

Operating temperature: 0°C to 40°C

Operating humidity: 10% to 85% RH

Network connectivity: 802.11 b/g/n 2.4GHz, BLE 5.0

Storage: Supports up to 512GB micro SD card

Dimension: 324(W) x 581(H) x 60(D)mm

Weight: 4.5kg

Safety information

- Keep your device away from heat and humidity, and make sure it does not close to fire or water.
- This product is a precision-based electronic product, please avoid physical damage.
- Do not attempt to disassemble, repair, or modify your device.
- Do not use your device where wireless devices are not allowed.

Return & Refund Policy

This product has a one-year warranty which begins from the date of purchase. The following situations do not fit the Return and Refund Policy.

- Intended damage or abuse.
- Inappropriate storage (damages caused by dropping or soaking in water).
- Modifying or repair of product.
- Natural wearing of product.
- Natural disasters.

Reset to Factory Settings

Learn how to reset your device to factory settings.

1. Go to Settings

Home > Settings button(ⓘ) > Settings

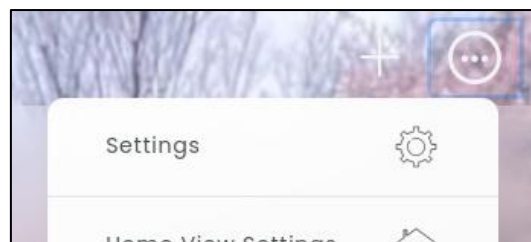

2. Go to System Settings

In Settings, click "System Settings".

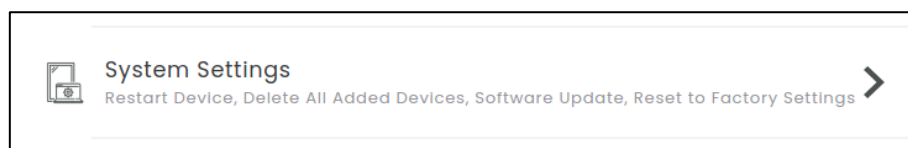

3. Reset to Factory Settings

In System Settings, find "Reset to Factory Settings", then click the Reset button.

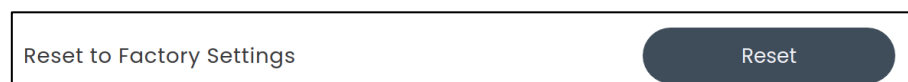

Next, confirm by clicking the Reset button.

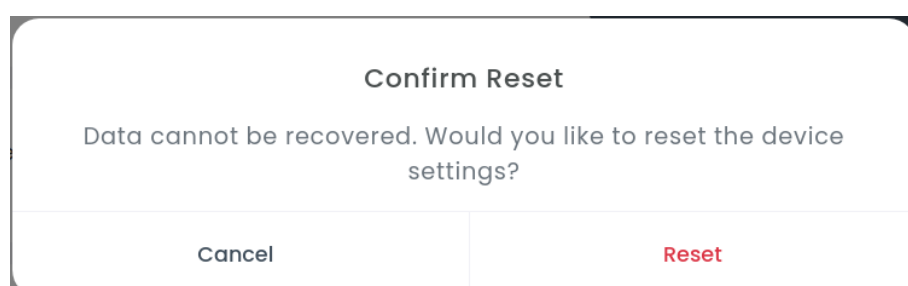

Getting started

Learn how to set up your SmartWiz⁺ mirror.

1. Turn on your SmartWiz⁺ mirror

Connect the provided AC adapter to a power outlet and wait for the next screen to display.

Notes

- Ensure the device is level and securely mounted to the wall.
- Ensure the power cable is correctly routed through the cable outlets to prevent the device from tilting during setup.

2. Set up your device

Read and accept the End-User License Agreement, then click the Proceed button.

End-User License Agreement

By using this product, you agree to be bound by the terms of the End-User License Agreement. Please read the agreement carefully before proceeding.

[End-User License Agreement]

This End-User License Agreement (hereinafter referred to as the "Agreement") is entered into between Dsign Incorporated (hereinafter referred to as "we" or "our company") and you (hereinafter referred to as "you" or "the customer") regarding the use of the software installed in the product (hereinafter referred to as the "Software"). By agreeing to the terms set forth below, you are granted the right to use the Software. By commencing the use of the Software, you acknowledge and agree to be bound by the terms of this Agreement. Therefore, please read the following "Software Use Terms" carefully before using the Software. Note that certain software components within the Software may be governed by separate "Terms of Use" or "End-User License Agreements," in which case such separate terms shall apply, and this Agreement shall not govern those components.

Software Use Terms:

1) Use and Copyright of the Software:

1.1. Subject to the terms of this Agreement, we grant you a limited and non-exclusive license (excluding the right to sublicense) to use one (1) copy of the Software in executable object code form, solely in conjunction with and for your personal, non-commercial use on the product owned or controlled by you.

1.2. Your purchase of the product grants you only the right to use the Software, and the copyright to the Software remains with us or the third-party developers.

2) Transfer to Third Parties:

If you transfer the Software to a third party, you agree to transfer all rights to the Software along with the product on which the Software is installed.

3) Modification, etc.:

You may not modify the Software, nor engage in reverse engineering, decompiling, or disassembling of the Software.

4) Open Source:

I agree

Proceed

Read through the quick guide, then click the Continue button.

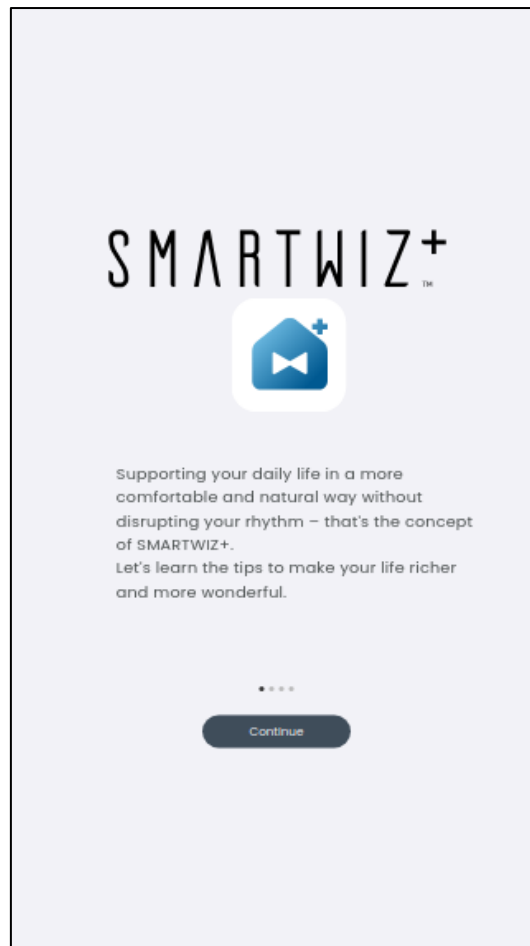

Set up your Wi-Fi Network.

Click the Refresh button (↻) to scan your network.

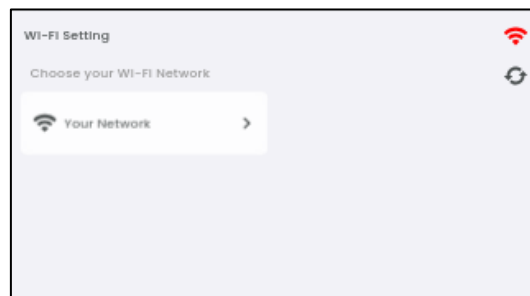

Enter your network's password, then click the Connect button.

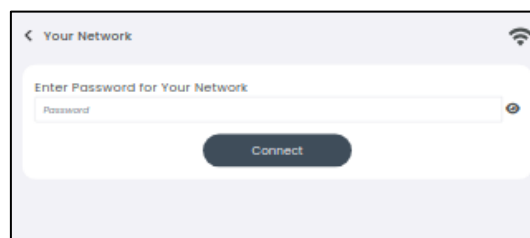

Next, set up your Time zone and Location.

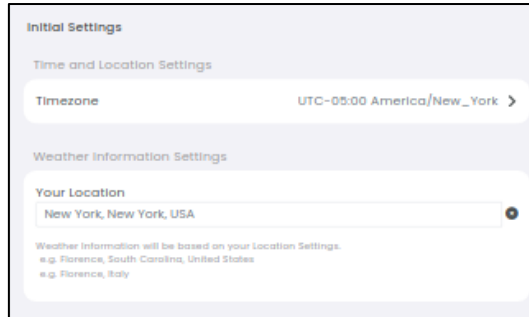

Set up the Room of your device.



Set up other preferences, then click the Continue button.

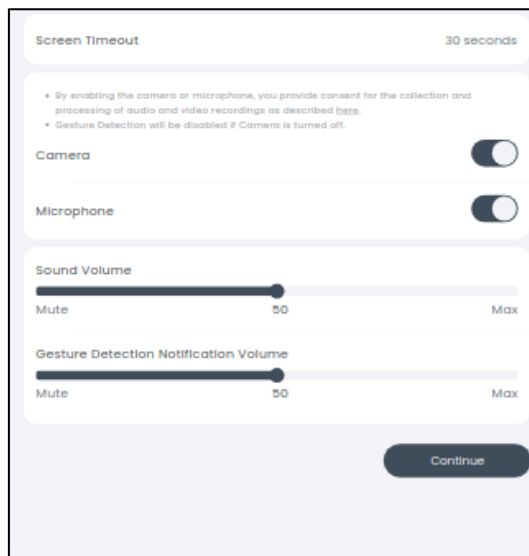

Next, click the Start button to finish the set up.

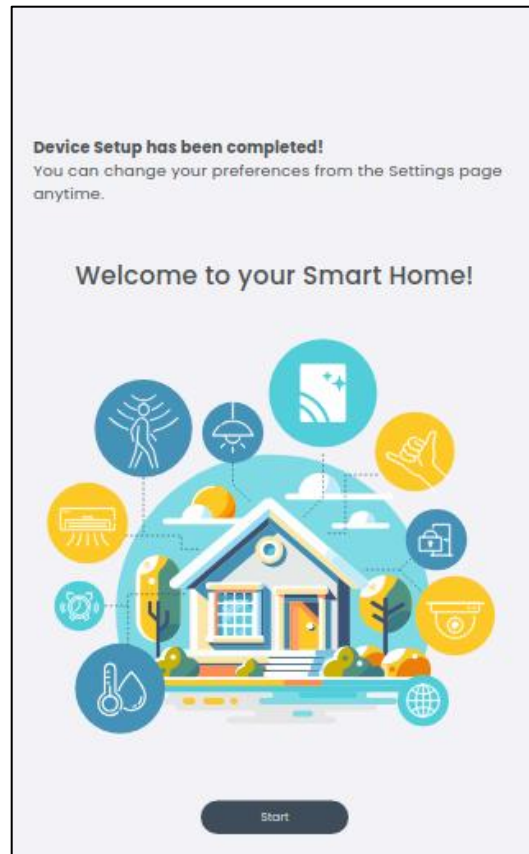

Set up and manage Matter-enabled devices

You can add your Matter-enabled devices to your SMARTWIZ+ mirror to control all your home devices. Matter-enabled smart home devices. Look for the Matter logo on the packaging.  matter

Learn how to add your Matter-enabled device.

1. Add Device

Home > Add button(+) > Add Device

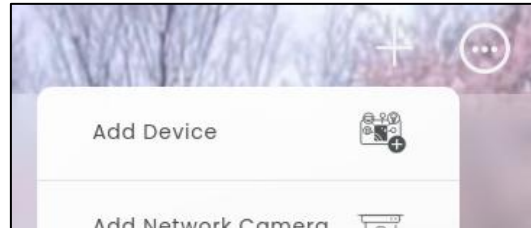

2. Add Device Using QR Code

In Add Device, click "Add Device Using QR Code".



In Add Device Using QR Code, click "Add a Device via Wi-Fi".



Follow the instructions on the next screens to scan your device's QR Code. Finish your device's settings, then click the Done button.

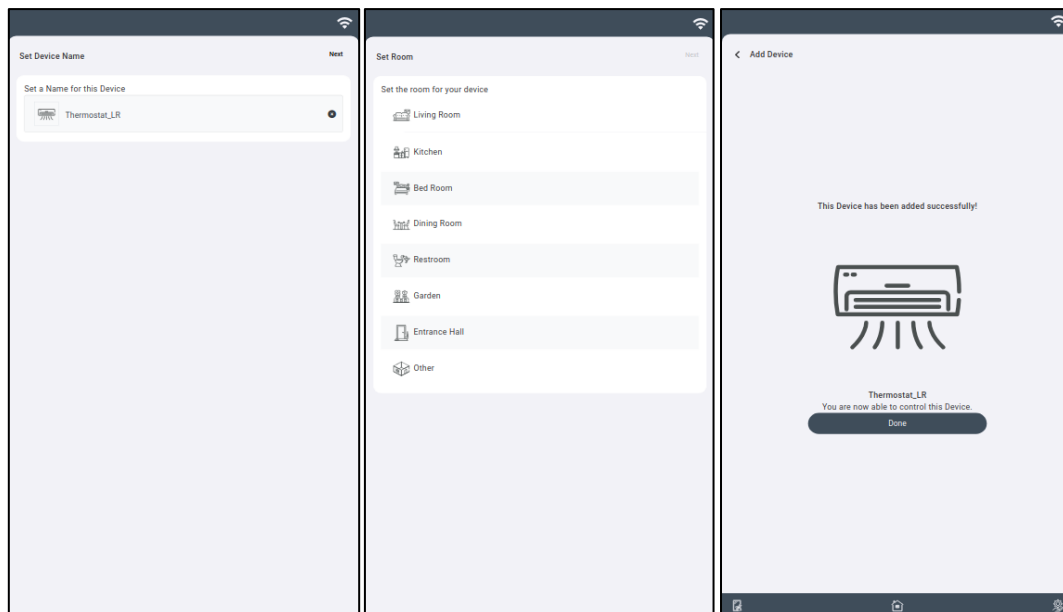

Find out more

Please visit <https://www.design-store.com/en/support/smartwiz> for more details.



CE Warning

To comply with RF exposure requirements, a separation distance of at least 20cm must be maintained between the user's body and the device (including the antenna). Use only provided or approved antennas. This device complies with the essential requirements of Directive 2014/53/EU and other relevant provisions. All mandatory radio test suites have been performed.

Hereby, Disign Incorporated declares that the radio equipment type SM215-X8M is in compliance with Directive 2014/53/EU. The full text of the EU Declaration of Conformity can be found in the User Manuals at: <https://www.disign-store.com/en/support/smartwiz>.

FCC Warning

This device complies with part 15 of the FCC Rules. Operation is subject to the following two conditions: (1) This device may not cause harmful interference, and (2) this device must accept any interference received, including interference that may cause undesired operation. Any changes or modifications not expressly approved by the party responsible for

compliance could void the user's authority to operate the equipment.

This equipment has been tested and found to comply with the limits for a Class B digital device, pursuant to part 15 of the FCC Rules. These limits are designed to provide reasonable protection against harmful interference in a residential installation. This equipment generates uses and can radiate radio frequency energy and, if not installed and used in accordance with the instructions, may cause harmful interference to radio communications. However, there is no guarantee that interference will not occur in a particular installation. If this equipment does cause harmful interference to radio or television reception, which can be determined by turning the equipment off and on, the user is encouraged to try to correct the interference by one or more of the following measures:

- Reorient or relocate the receiving antenna.
- Increase the separation between the equipment and receiver.
- Connect the equipment into an outlet on a circuit different from that to which the receiver is connected.
- Consult the dealer or an experienced radio/TV technician for help. The device has been evaluated to meet general RF exposure requirement. The device can be used in portable exposure condition without restriction.

FCC RF exposure statement:

The equipment complies with FCC Radiation exposure limit set forth for uncontrolled environment. This equipment should be installed and operated with minimum distance 20 cm between the radiator and your body.

WALL MOUNTING PROCEDURE

 prohibited

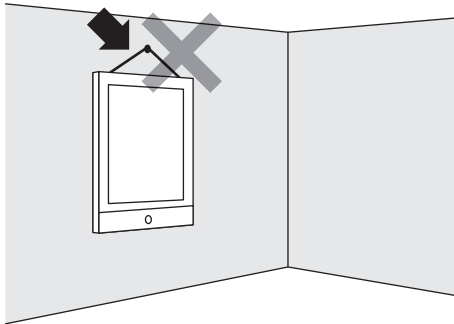

Preparation

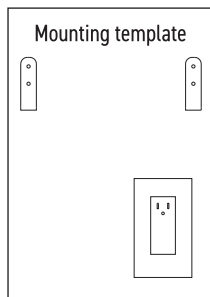
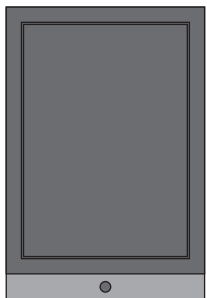
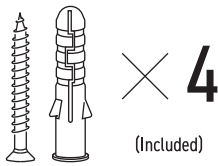
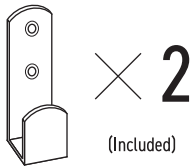
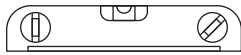
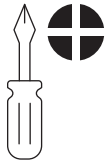

(Included)

Perform installation work

STEP 1

Paste the "Mounting template" on the installation wall and make sure it is level.

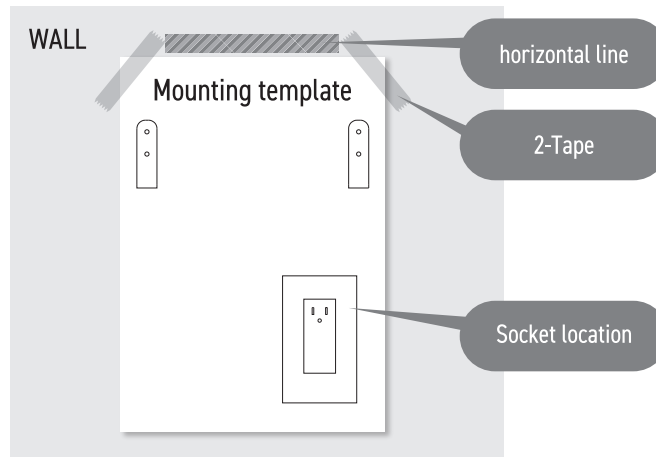

STEP 2

Fix the hooks with nails or screws according to the hook marks. Peel off the "mounting template" from the wall.

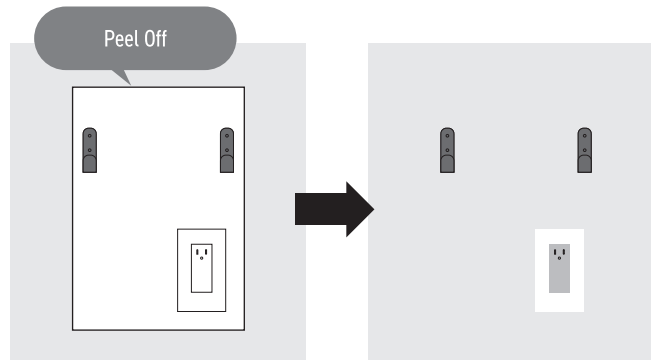
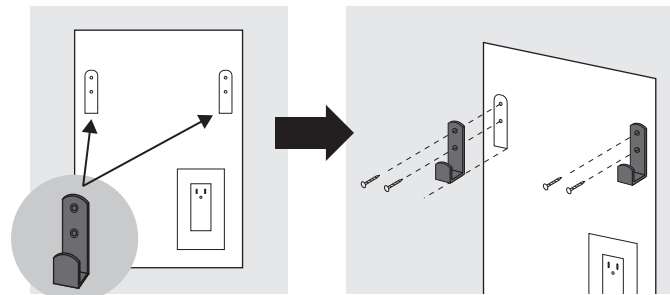

STEP 3

Insert the AC adapter into the wall socket and hang the product on the wall hook. Please ensure that both hooks are securely hanging the product.

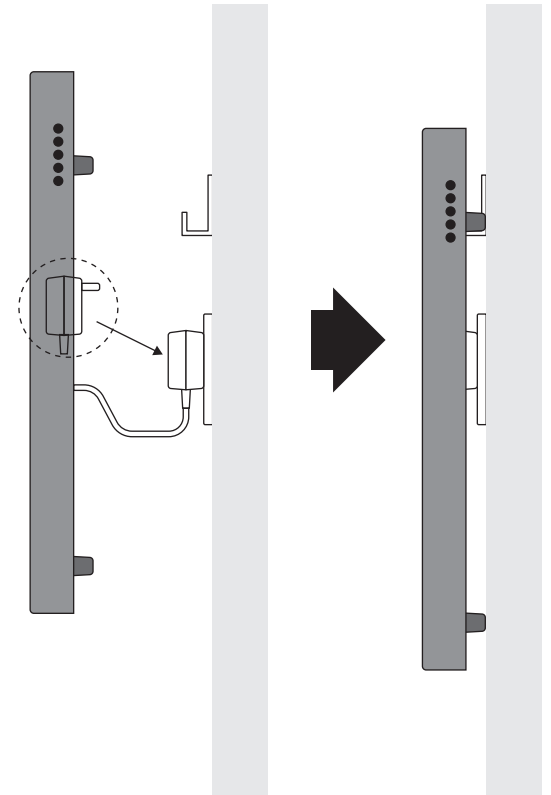

Caution

Work safely and wear appropriate protective gear during the installation process.

The type of screws that can be used varies depending on the wall material. Please use screws appropriate for the mounting surface regardless of the included screws.

Guide Position Map

